

super-wal

the double strut system

Most other dome companies offer 2x4 struts as standard or at best 2x6 as standard. Very few will even offer 2x8 as an option. Why? Probably because it's easy and cheap. For them, that is.

We learned several hundred domes ago that a 2x6 dome is not enough.

When Natural Spaces was formed in 1978, we had learned from six years of dome building and the energy crisis that old building methods were not going to carry us into the 21st century.

So, we invented the super-wal double strut system providing a true super insulated dome system.

When you buy a dome shell system from us, your super-wal struts come pre-assembled with sleeves attached ready to erect.

We learned how to manufacture a 15", 18" or 21" wide strut for the same price as our 2x10 strut. We learned how to produce and sell them for less money than our competitors 2x6 dome system.

Why do you need such a thick strut? To add more insulation and provide for wall cavity air ventilation.

Is there a maximum 'R' value or a point of diminishing returns? The additional investment you are making in the super-wal is so small that you get a fantastic return. If anyone can predict what the world energy picture will be like 10, 25 or 50 years from now, we'll tell you exactly what the payback is. Just think back 20 years ago. Now, don't you want something more than a 2x6 dome?

We also made our super-wal system easy to erect. Being pre-assembled, you don't have to go back and add anything or tighten or align anything.

Once you pound the bolt pin in place, your framework is locked rigidly together. You erect your double-strut dome framework in one day in one operation.

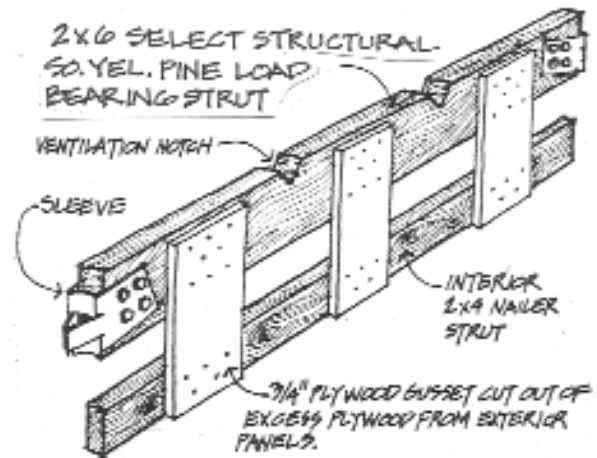

for superinsulating

Because we use safe, economical, fiberglass batt insulation, we have developed standard super-wal sizes:

Superwal	Insulation	Air Space	R-Value
12"	9 1/2"	2 1/2"	34
15"	6 1/4"& 6 1/4"	2 1/2"	44
18"	6 1/4"& 9 1/2"	2 1/4"	55
21"	9 1/2"& 9 1/2"	2"	66

Two 6" batts are cheaper than one 12" batt. We notch our struts and set back our sleeve to allow airflow between panels.

Our super-wal system includes the riser wall and the view cupola. It's a total superinsulated shell from the floor up.

Our super-wal double strut system is not a new experimental system. We've been building it for years. It's practical and economical to build. Best of all, it will save you thousands of dollars in your future fuel bills, providing you comfort of mind and body.

