

# large domes

Natural Spaces patented dome connection hardware is engineered for domes up to 80' in diameter. This catalog is geared to residential structures which usually means diameters from 26' to 49'. However, we do offer the following sizes:

Model 2100 52' diam. low profile  
Model 2300 54' diam. mid profile

Model 2600 58' diam. low profile  
Model 2800 60' diam. mid profile

Model 3300 65' diam. low profile  
Model 3500 67' diam. mid profile

Model 4000 72' diam. low profile  
Model 4300 74' diam. mid profile  
Model 4700 78' diam. low profile  
Model 5000 80' diam. mid profile

Projects with large domes have included: 72' diam. Dome for the city of Point Hope, Alaska (North of the Arctic Circle), for their city hall and community center; two 74' diam. domes for an Assembly of God 20,000 sq. ft. church complex near Indianapolis; 52' diam. erected at the summit of the Greenland ice cap.

Below is a triple dome church. It has a 49' mid-profile for offices, storage & meeting rooms; a 74' mid-profile sanctuary, & a 60' low-profile for fellowship hall & classrooms below.

Commercial, public & institutional domes require preparation of plans with complete engineering certification. Working with our consulting engineers, Natural Spaces can provide these services.

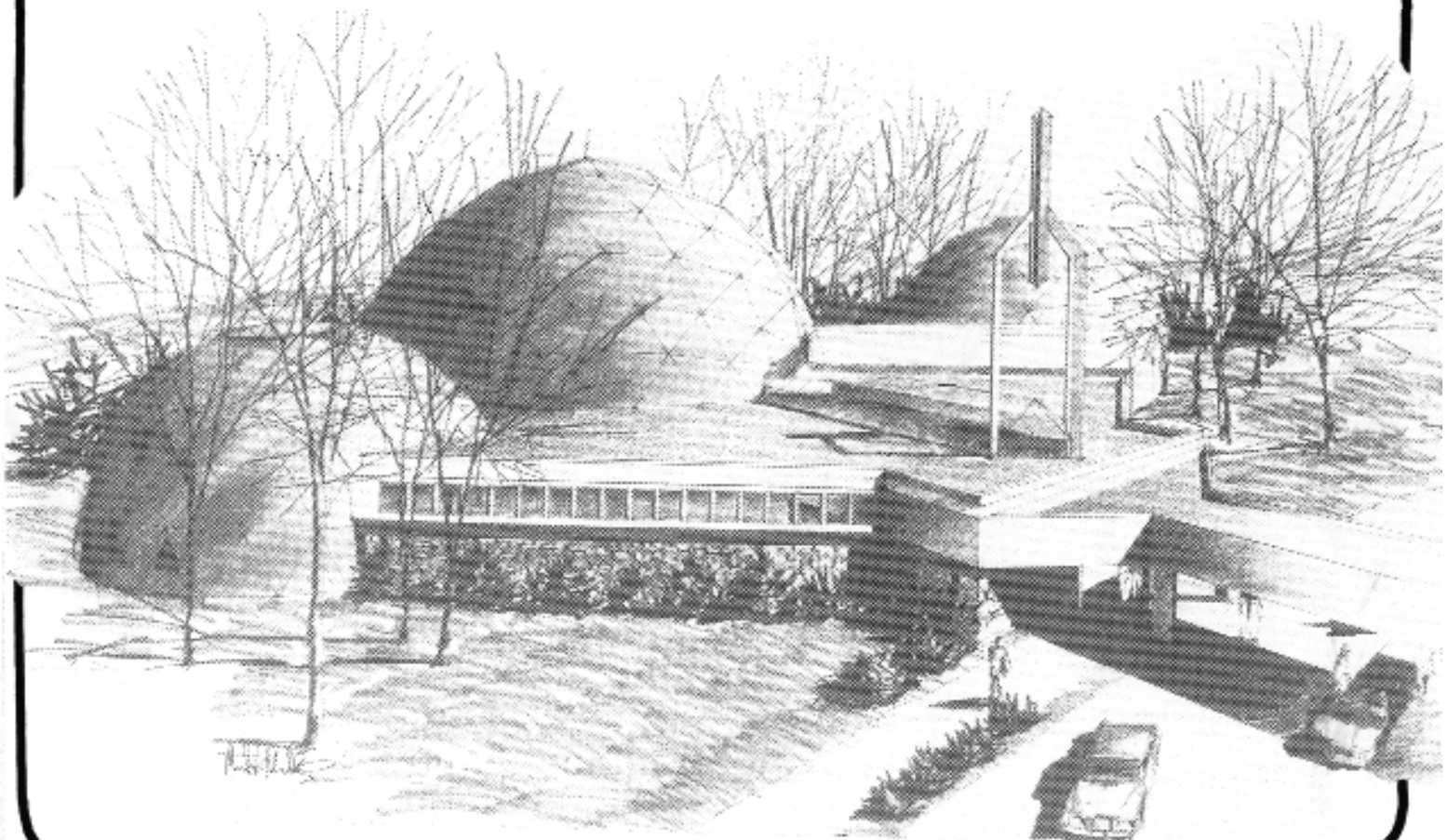

# commercial uses

The dome structure is a natural for any use requiring open space. To repeat an often used phrase - "Limited only by your imagination".

Natural Spaces can provide your custom fabricated dome components to meet commercial codes.

Our engineers can provide professionally-engineered designs to meet the most stringent code requirements.

Write or call us to discuss your concepts-our experience is your benefit.

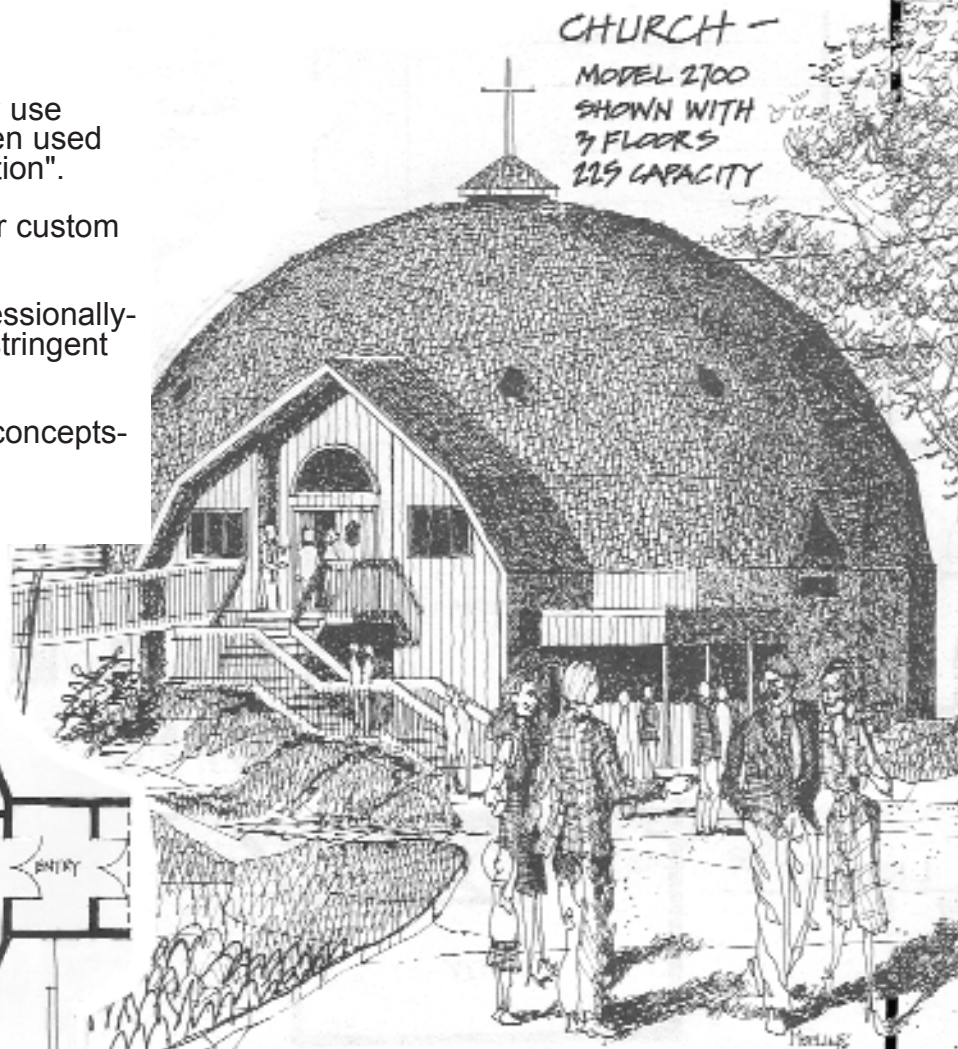
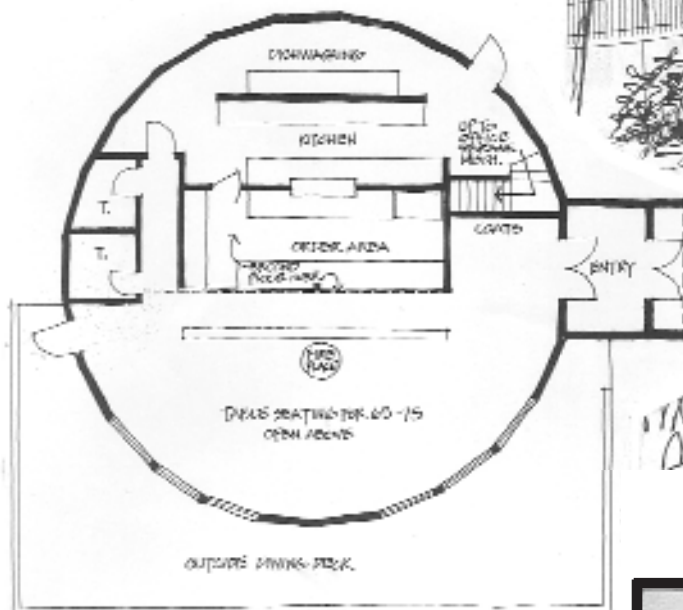

Dome restaurant at left is 52' diam. model 2000. Dome church above is 60' diam. model 2700. Dome church below is 74' diam. model 4300, part of 2 dome group.

## the DESIC -restaurant-

